



South Orlando Dock High Office Warehouse

1205 Pine Avenue
Orlando, FL 32824

Close Proximity To:

- Orlando International Airport
- Downtown Orlando
- Entertainment Complexes
- Easy access to the Beach Line, I-4, Hwy 417 and the Turnpike



UNIT SIZE:
5,100 SF

OFFICE FINISH:
580 SF

ELECTRICAL:
200amp - 3 phase
240 volt service

BUILDING:
18'+ Clear Height
10' x 10' Dock High Door
10' x 12' Door with Ramp

LEASE RATE:
\$6.50/SF Modified Gross

MINIMUM ONE YEAR LEASE

Jim Bankston, CCIM
Real Estate Broker

665 Harold Avenue
Winter Park, FL 32789

Phone: 407-256-8785
Fax: 866-232-2870
Email: jb@jcarinc.com

BROKERS PROTECTED





South Orlando Office Warehouse

1205 Pine Avenue • Orlando, FL 32824

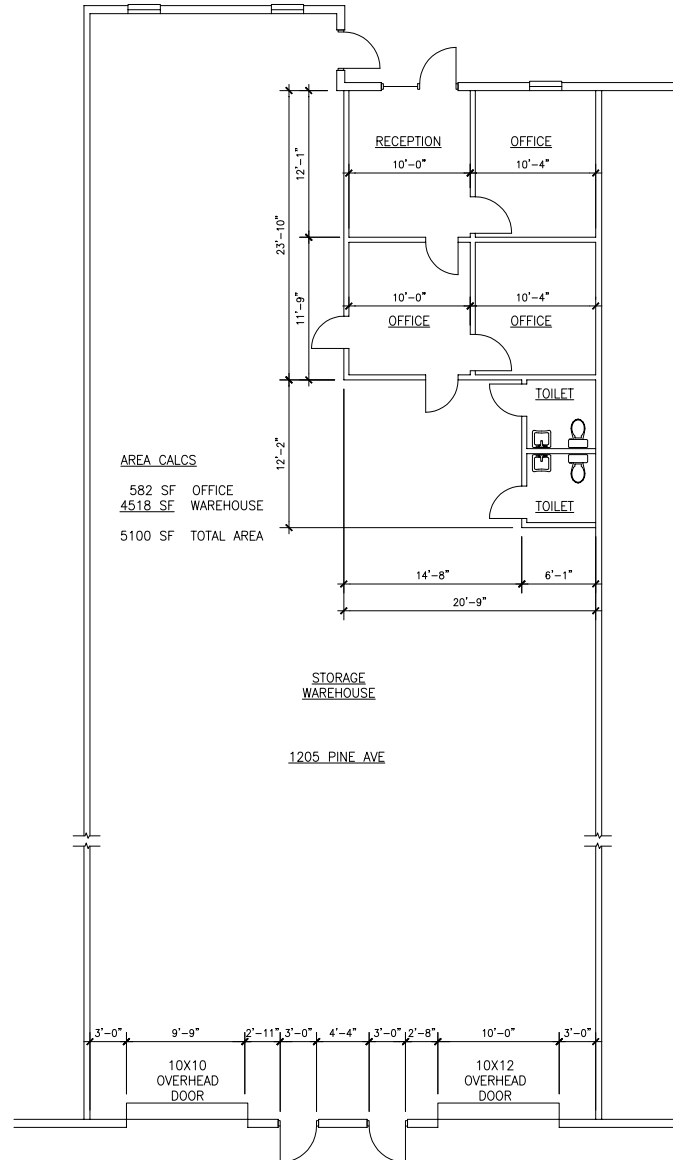

Jim Bankston, CCIM

Phone: 407-256-8785
Fax: 866-232-2870
Email: jb@jcarinc.com

Keflom M. Wolde

Phone: 407-405-4196
Fax: 866-232-2870
Email: kw@jcarinc.com

BROKERS PROTECTED

J-Car, Inc. • 665 Harold Avenue • Winter Park • FL 32789