



# South Orlando Grade Level Office Warehouse

6431 Milner Blvd.  
Orlando, FL 32809  
**Suite 6**

### Close Proximity To:

- Orlando International Airport
- Downtown Orlando
- Entertainment Complexes
- Easy access to the Beach Line, I-4, Hwy 417 and the Turnpike



**UNIT SIZE:**  
2,450 SF

**OFFICE FINISH:**  
650 SF

**ELECTRICAL:**  
200amp - 3 phase  
208 volt service

**BUILDING:**  
17'+ Clear Height  
10' x 14' Roll-up Door  
Warehouse Personnel Door

**LEASE RATE:**  
\$7.50/SF Modified Gross

**MINIMUM ONE YEAR LEASE**

Jim Bankston, CCIM  
Real Estate Broker

665 Harold Avenue  
Winter Park, FL 32789

Phone: 407-256-8785  
Fax: 866-232-2870  
Email: [jb@jcarinc.com](mailto:jb@jcarinc.com)

**BROKERS PROTECTED**





# South Orlando Office Warehouse

6431 Milner Blvd • Orlando, FL 32809 • Suite 6

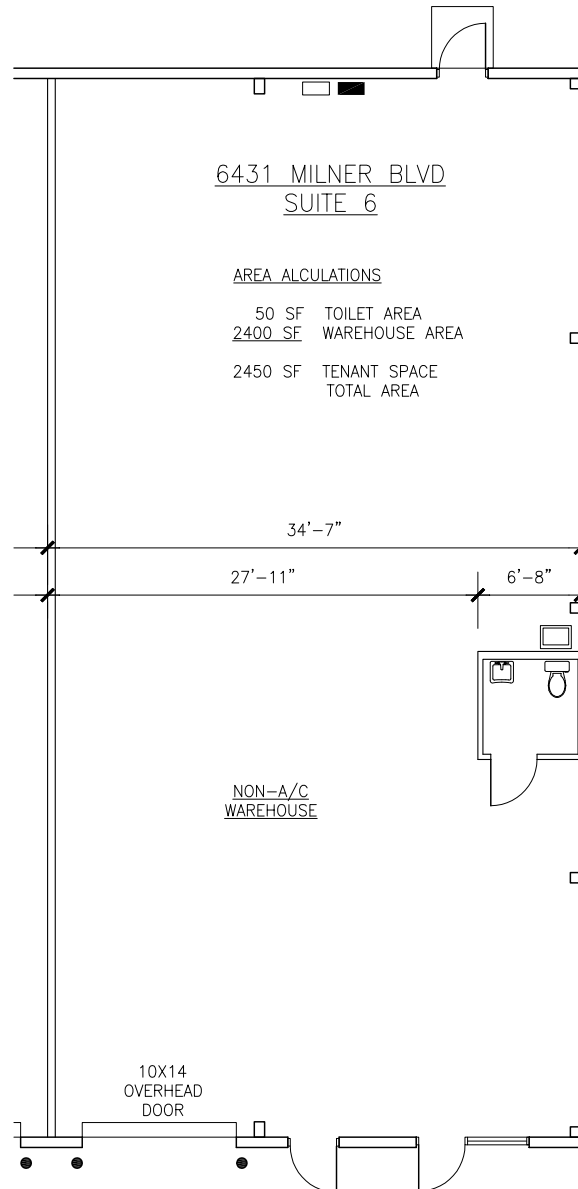

**Jim Bankston, CCIM**

Phone: 407-256-8785  
Fax: 866-232-2870  
Email: [jb@jcarinc.com](mailto:jb@jcarinc.com)

**Keflom M. Wolde**

Phone: 407-405-4196  
Fax: 866-232-2870  
Email: [kw@jcarinc.com](mailto:kw@jcarinc.com)

**BROKERS PROTECTED**

J-Car, Inc. • 665 Harold Avenue • Winter Park • FL 32789